



New Age Series | NASL-PS 2x4

Date		Notes
Project		
Type	Qty	

Features

- Durable steel housing with perforated side baskets.
- LED optimized optics for smooth even illumination.
- High efficiency driver; custom lumen packages.
- 0-10V dimming to 1% standard or Dim-to-Off
- Options for 90CRI, Tunable White, RGB, RGBW, and RGBWW.
- Bios SkyBlue™ circadian solutions available.
- Declare** Red List Approved.

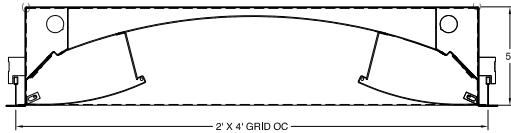

Ordering Guide

MODEL	OPTICS	CCT	LUMENS	SIZE	MOUNTING ⁴	FINISH	OPTIONS
NASL-PS-D	PF			24			
NASL-PS-D Direct	PF = Perforated with white acrylic overlay.	STATIC WHITE¹ 27 = 2700K 30 = 3000K 35 = 3500K 40 = 4000K 50 = 5000K BIOS SkyBlue² Spectrally optimized circadian solutions. TUNABLE WHITE³ (2700K-6500K) 2DIM10 = for 0-10V 2DMX = for DMX 2ESN = for Philips 2CAS = for Casambi DIM-TO-WARM (2700K-6500K) DTW = Dim-to-Warm RGB & WHITE³ RGB = RGB RGBW = RGBW RGBWW = RGBWW	STANDARD LO = 3975 (42W, 95LPW) SO = 5300 (56W, 95LPW) HO = 6600 (70W, 92LPW) CUSTOM For custom lumens please specify any value < HO.	24 = 2x4	G = Grid 15/16" T-Bar MG = Mini Grid 9/16" T-Bar SG = Slot Grid SGF = Slot Grid Flush XG = Interlude XGF = Interlude Flush TGF = Tegular Flush 15/16" T-Bar XGF = Tegular Flush 9/16" T-Bar S = Surface F = Flange See all mount- ing options page 4.	W = White CC = Custom Color AMW = Anti-Microbial White	DIMMING DRIVERS DIM10 = 0-10V (1%) - Standard DTO = 0-10V (Dim-to-Off) DIMST = 0-10V Step Dimming 347 = 0-10V (347V) DIMSR = DALI Sensor Ready (5.0%) DALI = DALI (5.0%) DMX = DMX LUTRON™ DIMMING DRIVERS LDE1 = Hi-Lume™ 1% EcoSystem™ L3DA3W = Hi-Lume™ 1% 3-Wire EMERGENCY & OTHER EMC = Emergency Circuit EPC4 = 4W Emergency Battery Pack EPC6 = 6.5W Emergency Battery Pack EPC10 = 10W Emergency Battery Pack EPC12 = 12W Emergency Battery Pack FWH = Flexible Whip Harness CAS = Casambi Wireless Control

¹ CCT @ 80+CRI, 3SDCM. For 90CRI add prefix "9"; ex: 935 = 3500K, 90CRI.

² BIOS SkyBlue Biological Static & Dynamic page 3.

³ Tunable White, Dim-to-Warm, and RGB & White codes page 2.

⁴ See page 4 for all mounting options.

Grid Ceiling Mounting Options

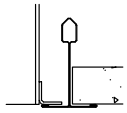

15/16" T-Bar
(G)

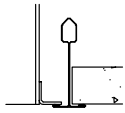

9/16" T-Bar
(MG)

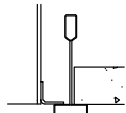

Slot Grid
(SG)

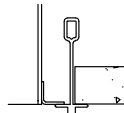

Interlude
(XG)

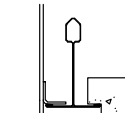

15/16" Tegular
Flush
(TGF)

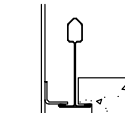

9/16" Tegular
Flush
(MTGF)

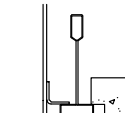

Slot Grid Flush
(SGF)

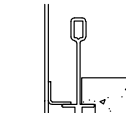

Interlude Flush
(XGF)

Additional Mounting Options

Photometry

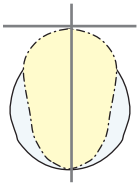

NASL-PS-D-PF-40-LO-24

CCT: 4000K
WATTS: 42
LUMENS: 3975
LPW: 95
Distribution:
100% Direct

NASL-PS-D-PF-40-SO-24

CCT: 4000K
WATTS: 56
LUMENS: 5300
LPW: 95
Distribution:
100% Direct

Specifications

CONSTRUCTION: 20 gauge CRS housing and internal components.

REFLECTOR: 20 gauge CRS finished in highly reflective baked white enamel with pre-finished reflective LED tray.

OPTICS: Perforated with white acrylic overlay.

LED: Static white LED modules in 30/35/40 & 50K CCT, 80/90CRI. Lumen maintenance minimum L_{70} = 50,000 hours. 3 SDCM color consistency. BIOS SkyBlue, RGB, RGBW, RGBWW. Tunable White and Dim-to-Warm options available; field replaceable.

DRIVER: Standard driver is Class 2 AOC 0-10V to 1%, Dim-to-Off available. 120/277V input, PF > 90%, THD < 20 @ 120V. Additional dimming protocols available. All drivers prewired from factory for connection to control system (by others); field replaceable.

MOUNTING: Standard installation is in an exposed inverted T-bar ceiling. Fixtures are supplied with four support brackets for additional support to T-bar. May also be installed in a plaster ceiling (F/TRL mounting option with Flange); field replaceable.

FINISH: Housing and components finished in baked white enamel.

CERTIFICATION: cETLus listed conforming to UL STD. 1598 and certified to CSA STD C22.2 NO. 250.0. Suitable for dry & damp locations. Union Made in the United States of America. I.B.E.W. RoHS and BAA compliant. DLC V5.1 Standard Listed. Declare Red List Approved.

LEGAL: Day-O-Lite, a division of SCW Corporation. All rights reserved. The Day-O-Lite logo is a registered trademark of SCW Corporation. Day-O-Lite reserves the right to change specifications without notice for product improvement.

WEIGHT: Nominal fixture weight XX lbs.